



# NO DOWNTIME DURING CLEAN-OUT

## Ideal for tool makers, rapid prototyping and technical molding.

### NO INTERRUPTION

No interruption of the drying process occurs during on-the-fly material change.

### SPEED OF DRYING

The LPD Vacuum Dryer dries resin six times faster than desiccant dryers.

### ENERGY SAVINGS

Side-by-side testing of the vacuum dryer and a desiccant dryer shows reduced energy consumption of 60% less energy.

### 3-STAGE DRYING TECHNOLOGY

Unique patented 3-stage drying technology with "zero maintenance" required as the use of desiccant is not required.

### LOW MATERIAL STRESS

Due to quick drying time, material is not put under un-due stress, eliminating material degradation.

### TECHNICAL MATERIALS

The LPD vacuum dryer dries technical materials, such as PA, rapidly and precisely ensuring product quality.

### MODULAR SYSTEM

The modular nature of the LPD dryer allows for increased throughput with larger heating hopper.

### SIMPLE CONTROL

The LPD controller can be easily removed for service or replacement and replaced in minutes. The main functions are set simply via two thumbwheels on the LPD controller.

### ALARMS

Alarms are shown on the display and signalled by an audible alarm and strobe light with silence function. The last 35 alarms are recorded via the keypad.

### MATERIAL MANAGEMENT

The LPD-30 produces smaller batches for better material management.

### 5-YEAR WARRANTY

Backed by our 5 year warranty program, no exclusions, no registration.

### REDUCED FLOOR SPACE

The floor space required for this vacuum drying unit is reduced as there are no separate drying hoppers required.





## Dimensions:

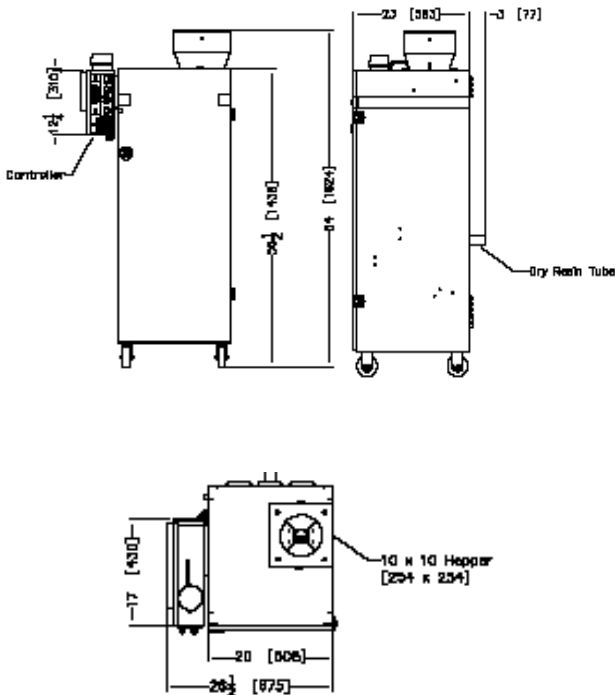

MATERIALS DRYING TIMES				
Material	Final Moisture %	Cycle Time	Drying Temp°C	kW/Kg
ABS	0.10	20-25	80-85	0.053
ABS/PC	0.02	25-30	100	0.082
LCP	0.02	20-50	150	0.144
PA	0.20-0.10	20-30	80-85	0.051
PBT	0.02	20-25	120	0.087
PC	0.02	20-25	120	0.087
PC/PBT	0.02	20-25	125	0.090
PEEK	0.20-0.10	25-30	150	0.104
PEI	0.02	30-40	150	0.156
PES	0.05-0.02	25-30	150	0.130
PET IMM	0.01	30-35	150	0.137
PMMA	0.02-0.04	30	85	0.079
POM	0.20-0.10	25	80-110	0.065
PPO	0.02	25	100-120	0.100
PPS	0.02	25	150	0.150
PUR	0.02	25	125-140	0.115
Max	0.02	25-30	150	0.150
PSU	0.20-0.10	20-40	80	0.056

## Throughput Ranges:

Sample Kg/h throughput rates based on typical 0.7 bulk density at different cycle times. This information is for guideline purposes only and does not represent a guaranteed Kg/kW value.

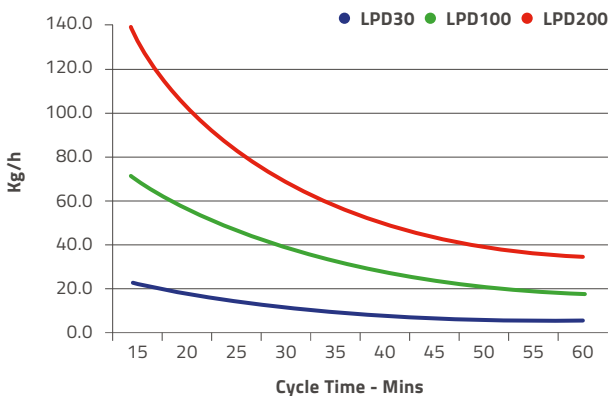

TECHNICAL DATA	
Model	LPD-30
Throughput (Based on 20min cycle time)	15kg/h - 33lb/h
Canister Volume	9 litres - 0.32cu ft
Max Temperature	180°C - 356°F
Installed Power	4.37Kw
Pump kW	0.37kw
Compressed Air Usage	0.25m³/h - 0.147cfm
Shipping Weight & Size	300Kg - 660lb 100x90x190cm 40x35x75inches

### MAGUIRE WORLDWIDE DISTRIBUTION LOCATIONS



#### Maguire USA

Aston, PA, USA  
T: +1 610 459 4300  
F: +1 610 459 2700  
E: info@maguire.com

#### Maguire Canada

Ontario, Canada  
T: +1 905 879 1100  
F: +1 905 879 1101  
E: info@maguirecanada.com

#### Maguire Europe

Staffordshire, UK  
T: +44 1827 338 280  
F: +44 1827 338 285  
E: info@maguire-europe.com

#### Maguire IMEA

Dubai, UAE  
T: +971 4 881 6700  
E: info@maguire-imea.com

#### Maguire Asia

Singapore  
T: +65 6848 7117  
F: +65 6542 8577  
E: magasia@maguire-products.com.sg

#### Maguire China

Shanghai  
T: +86 21 5882 3410  
F: +86 21 5882 3420  
E: amber@maguirechina.com



# NO DOWNTIME DURING CLEAN-OUT

## Ideal for tool makers, rapid prototyping and technical molding.

### NO INTERRUPTION

No interruption of the drying process occurs during on-the-fly material change.

### SPEED OF DRYING

The LPD Vacuum Dryer dries resin six times faster than desiccant dryers.

### ENERGY SAVINGS

Side-by-side testing of the vacuum dryer and a desiccant dryer shows reduced energy consumption of 60% less energy.

### 3-STAGE DRYING TECHNOLOGY

Unique patented 3-stage drying technology with "zero maintenance" required as the use of desiccant is not required.

### LOW MATERIAL STRESS

Due to quick drying time, material is not put under un-due stress, eliminating material degradation.

### TECHNICAL MATERIALS

The LPD vacuum dryer dries technical materials, such as PA, rapidly and precisely ensuring product quality.

### MODULAR SYSTEM

The modular nature of the LPD dryer allows for increased throughput with larger heating hopper.

### SIMPLE CONTROL

The LPD controller can be easily removed for service or replacement and replaced in minutes. The main functions are set simply via two thumbwheels on the LPD controller.

### ALARMS

Alarms are shown on the display and signalled by an audible alarm and strobe light with silence function. The last 35 alarms are recorded via the keypad.

### MATERIAL MANAGEMENT

The LPD-100 produces smaller batches for better material management.

### 5-YEAR WARRANTY

Backed by our 5 year warranty program, no exclusions, no registration.

### REDUCED FLOOR SPACE

The floor space required for this vacuum drying unit is reduced as there are no separate drying hoppers required.





## Dimensions:

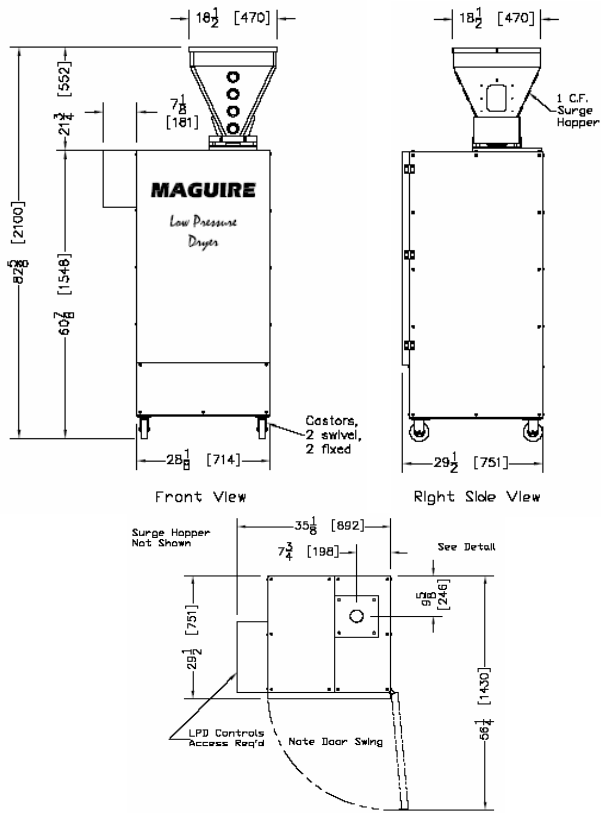

MATERIALS DRYING TIMES				
Material	Final Moisture %	Cycle Time	Drying Temp°C	kW/Kg
ABS	0.10	20-25	80-85	0.038
ABS/PC	0.02	25-30	100	0.045
LCP	0.02	20-50	150	0.097
PA	0.20-0.10	20-30	80-85	0.040
PBT	0.02	20-25	120	0.046
PC	0.02	20-25	120	0.046
PC/PBT	0.02	20-25	125	0.050
PEEK	0.20-0.10	25-30	150	0.075
PEI	0.02	30-40	150	0.078
PES	0.05-0.02	25-30	150	0.065
PET IMM	0.01	30-35	150	0.065
PMMA	0.02-0.04	30	85	0.046
POM	0.20-0.10	25	80-110	0.050
PPO	0.02	25	100-120	0.065
PPS	0.02	25	150	0.069
PUR	0.02	25	125-140	0.055
Max	0.02	25-30	150	0.069
PSU	0.20-0.10	20-40	80	0.053

## Throughput Ranges:

Sample Kg/h throughput rates based on typical 0.7 bulk density at different cycle times. This information is for guideline purposes only and does not represent a guaranteed Kg/kW value.

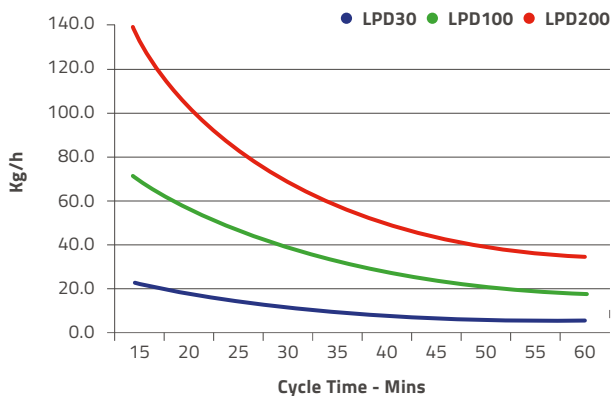

TECHNICAL DATA	
Model	LPD-100
Throughput (Based on 20min cycle time)	50kg/h - 112lb/h
Canister Volume	27litres 1cu ft
Max Temperature	180°C - 356°F
Power Supply	415vac
Installed Power	7.9Kw
Pump kW	1.86kw
Compressed Air Usage	0.8m³/h - 0.5cfm
Compressed Air Supply	7bar - 90psi
Shipping Weight & Size	400Kg - 880lbs 100x90x220cm 40x35x85inches

### MAGUIRE WORLDWIDE DISTRIBUTION LOCATIONS



#### Maguire USA

Aston, PA, USA  
T: +1 610 459 4300  
F: +1 610 459 2700  
E: info@maguire.com

#### Maguire Canada

Ontario, Canada  
T: +1 905 879 1100  
F: +1 905 879 1101  
E: info@maguirecanada.com

#### Maguire Europe

Staffordshire, UK  
T: +44 1827 338 280  
F: +44 1827 338 285  
E: info@maguire-europe.com

#### Maguire IMEA

Dubai, UAE  
T: +971 4 881 6700  
E: info@maguire-imea.com

#### Maguire Asia

Singapore  
T: +65 6848 7117  
F: +65 6542 8577  
E: magasia@maguire-products.com.sg

#### Maguire China

Shanghai  
T: +86 21 5882 3410  
F: +86 21 5882 3420  
E: amber@maguirechina.com



# NO DOWNTIME DURING CLEAN-OUT

## Ideal for tool makers, rapid prototyping and technical molding.

### NO INTERRUPTION

No interruption of the drying process occurs during on-the-fly material change.

### SPEED OF DRYING

The LPD Vacuum Dryer dries resin six times faster than desiccant dryers.

### ENERGY SAVINGS

Side-by-side testing of the vacuum dryer and a desiccant dryer shows reduced energy consumption of 60% less energy.

### 3-STAGE DRYING TECHNOLOGY

Unique patented 3-stage drying technology with “zero maintenance” required as the use of desiccant is not required.

### LOW MATERIAL STRESS

Due to quick drying time, material is not put under un-due stress, eliminating material degradation.

### TECHNICAL MATERIALS

The LPD vacuum dryer dries technical materials, such as PA, rapidly and precisely ensuring product quality.

### MODULAR SYSTEM

The modular nature of the LPD dryer allows for increased throughput with larger heating hopper.

### SIMPLE CONTROL

The LPD controller can be easily removed for service or replacement and replaced in minutes. The main functions are set simply via two thumbwheels on the LPD controller.

### ALARMS

Alarms are shown on the display and signalled by an audible alarm and strobe light with silence function. The last 35 alarms are recorded via the keypad.

### MATERIAL MANAGEMENT

The LPD-200 produces smaller batches for better material management.

### 5-YEAR WARRANTY

Backed by our 5 year warranty program, no exclusions, no registration.

### REDUCED FLOOR SPACE

The floor space required for this vacuum drying unit is reduced as there are no separate drying hoppers required.

### EASIER PRODUCTION PLANNING

The floor space required for this vacuum drying unit is reduced as there are no separate drying hoppers required.





## Dimensions:

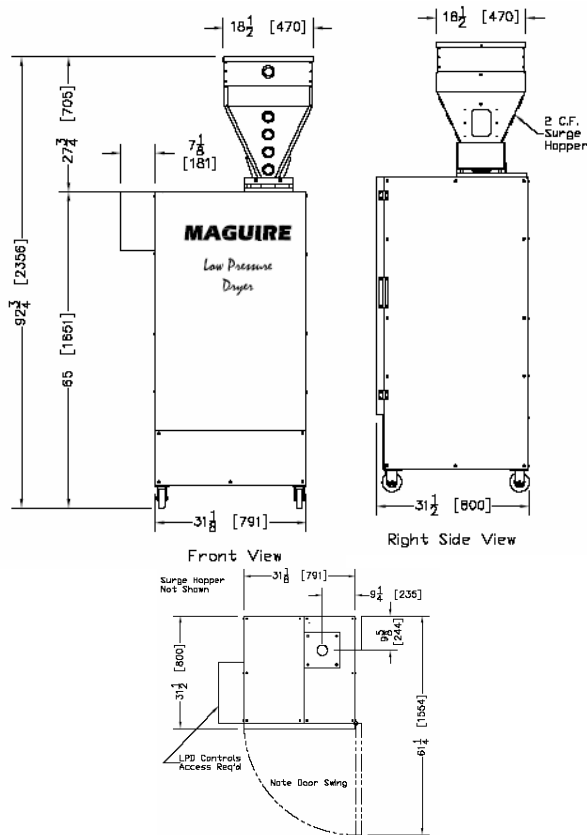

MATERIALS DRYING TIMES				
Material	Final Moisture %	Cycle Time	Drying Temp°C	kW/Kg
ABS	0.10	20-25	80-85	0.034
ABS/PC	0.02	25-30	100	0.042
LCP	0.02	20-50	150	0.080
PA	0.20-0.10	20-30	80-85	0.036
PBT	0.02	20-25	120	0.038
PC	0.02	20-25	120	0.040
PC/PBT	0.02	20-25	125	0.040
PEEK	0.20-0.10	25-30	150	0.062
PEI	0.02	30-40	150	0.064
PES	0.05-0.02	25-30	150	0.053
PET IMM	0.01	30-35	150	0.053
PMMA	0.02-0.04	30	85	0.042
POM	0.20-0.10	25	80-110	0.042
PPO	0.02	25	100-120	0.053
PPS	0.02	25	150	0.057
PUR	0.02	25	125-140	0.043
Max	0.02	25-30	150	0.057
PSU	0.20-0.10	20-40	80	0.053

## Throughput Ranges:

Sample Kg/h throughput rates based on typical 0.7 bulk density at different cycle times. This information is for guideline purposes only and does not represent a guaranteed Kg/kW value.

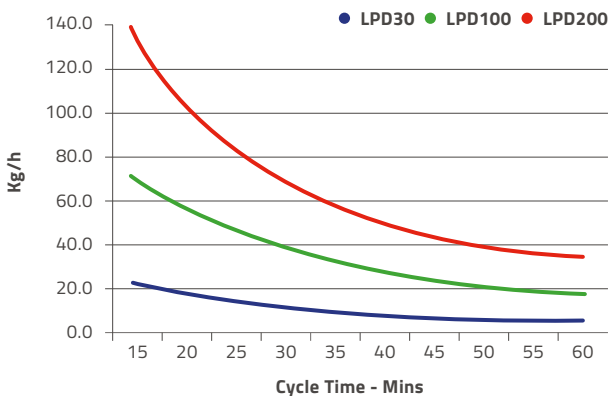

TECHNICAL DATA	
Model	LPD-200
Throughput (Based on 20min cycle time)	110kg/h - 240lb/h
Canister Volume	57 litres - 2cu ft
Max Temperature	180°C - 356°F
Power Supply	415v AC
Installed Power	13.6Kw
Pump kW	2.7kw
Compressed Air Usage	1.2m <sup>3</sup> /h - 0.7cfm
Compressed Air Supply	7bar - 90psi
Shipping Weight & Size	520kg - 144lbs 100x90x240cm 40x35x95inches

## MAGUIRE WORLDWIDE DISTRIBUTION LOCATIONS



### Maguire USA

Aston, PA, USA  
T: +1 610 459 4300  
F: +1 610 459 2700  
E: info@maguire.com

### Maguire Canada

Ontario, Canada  
T: +1 905 879 1100  
F: +1 905 879 1101  
E: info@maguirecanada.com

### Maguire Europe

Staffordshire, UK  
T: +44 1827 338 280  
F: +44 1827 338 285  
E: info@maguire-europe.com

### Maguire IMEA

Dubai, UAE  
T: +971 4 881 6700  
E: info@maguire-imea.com

### Maguire Asia

Singapore  
T: +65 6848 7117  
F: +65 6542 8577  
E: magasia@maguire-products.com.sg

### Maguire China

Shanghai  
T: +86 21 5882 3410  
F: +86 21 5882 3420  
E: amber@maguirechina.com